

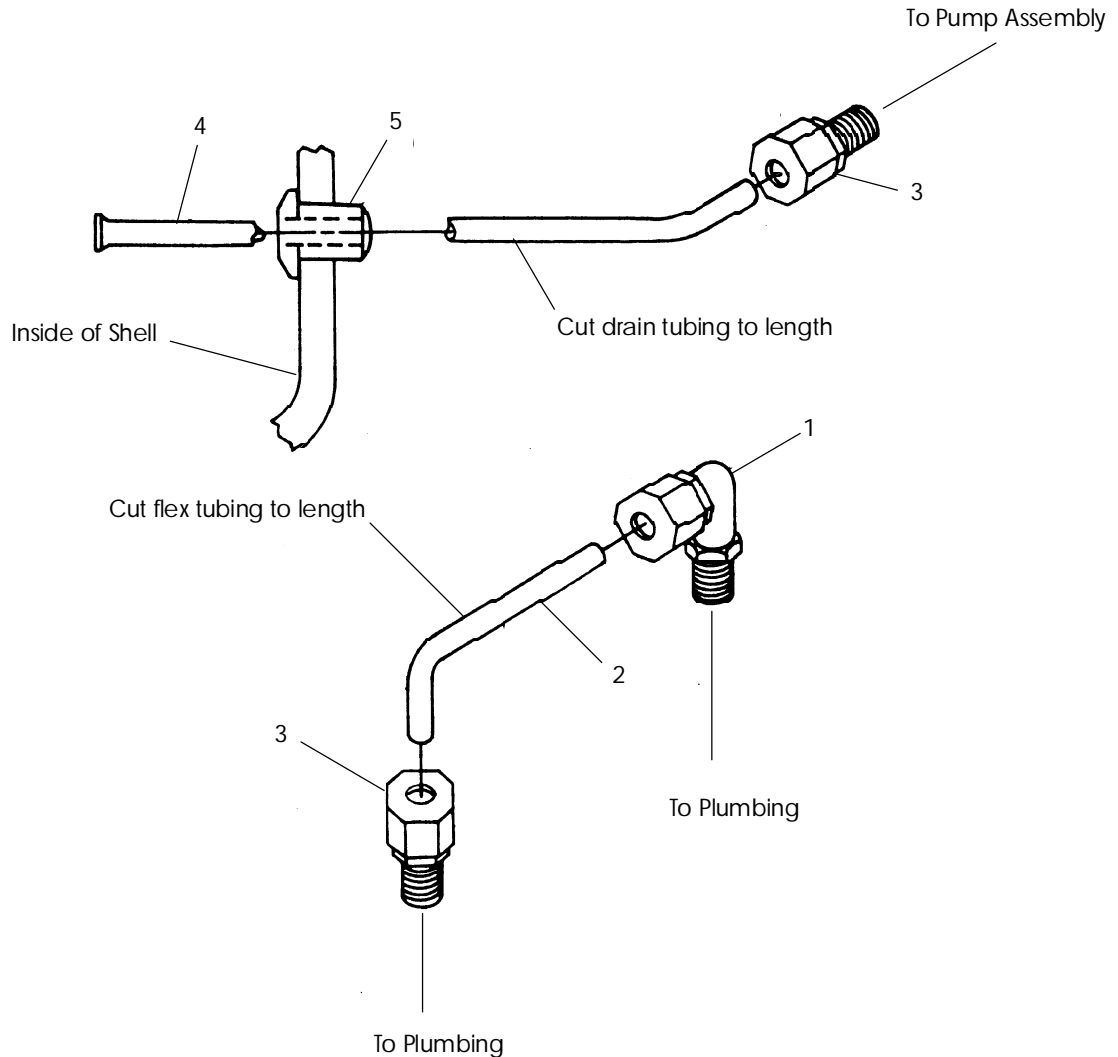

BATHS

VENT/DRAIN ASSEMBLIES



NOTE: From inside of bath, insert drain tube, Item 4, into grommet, Item 5. From outside of bath, pull drain tube until flared end of tube is seated in grommet. To ensure maximum drainage, cut drain tube to proper length. To install compression fittings in plumbing, drill 5/16" diameter thru hole and tap for 1/8 NPT.

ITEM	P/N	DESCRIPTION	QTY
1	3044000	Compression Fitting, 90 Ell, .25"	1
2	4649000	Tube, .25" O.D. Flex Nylon x 75.00"L.	1
3	3054000	Compression Fitting, Straight, .25"	2
4	7266000	Drain Tube, .25" x 46.00"L.	1
5	6460000	Grommet, Drain	1



BATHS

DRAIN/OVERFLOW

ITEM	P/N	DESCRIPTION	QTY
1	2618000	Elbow, 90, Overflow	1
2	2648000	Gasket, Overflow Seal	1
3	3597000	Retainer Plate	1
4	2660000	Screw, PHP, Thread Roll, #10-24 x 1.75"L.	2
5	3638000	Fastener, Push-On Type	2
6	3595000	Rod, Actuator	2
7	2653000	Clamp, Rod	1
8	5661000	Plunger Assembly	1
9	3591000	Gasket, Waste Seal	1
10	3590000	Elbow, 90, Waste	1
11	2641000	Nut, Tube, 1 1/2"	2
12	2642000	Washer, Slip Joint, 1 1/2"	2
13	3588000	Tee, 1 1/2" x 1 1/2" x 1 1/2"	1
14	3589000	Tail Piece	1
15	4648000	Tube, 1 1/2" O.D., Overflow, 23.88"L.	1
16	4647000	Tube, 1 1/2" O.D., Waste, 15.88"L.	1

ITEM	P/N	DESCRIPTION	QTY
17	8678848	Screw, 1/4-20 x 2" L. OHPM, Chrome	2
18	4175827	Modified Trip Lever Assy, Chrome	1
19	4132827	Strainer, Chrome	1
20	4131827	Waste Flange, Chrome	1

ITEM	P/N	DESCRIPTION	QTY
17	4189828	Screw, 1/4-20 x 2" L. OHPM, Gold	2
18	4175828	Modified Trip Lever Assy, Gold	1
19	4132828	Strainer, Gold	1
20	4131828	Waste Flange, Gold	1

ITEM	P/N	DESCRIPTION	QTY
17	4189829	Screw, 1/4-20 x 2" L. OHPM, Bright Brass	2
18	4175829	Modified Trip Lever Assy, Bright Brass	1
19	4132829	Strainer, Bright Brass	1
20	4131829	Waste Flange, Bright Brass	1

